



ISSUE DATES

ISSUE DATES	

09-16-2018 | EXISTING PLAN

ONE MASON PLAZA
811 SOUTH MASON ROAD KATY, TX 77449
SUITE 200a

PROJECT: 811 ONE MASON PLAZA	
PLOTTED SCALE: 1/8"=1'-0"	SHEET SIZE: 8.5 X 11
CHECKED BY: WM	DRAWN BY: WM
FILENAME: 811ONE MASON PLAZA	

SHEET TITLE
EXISTING PLAN

SHEET NUMBER
EX-1

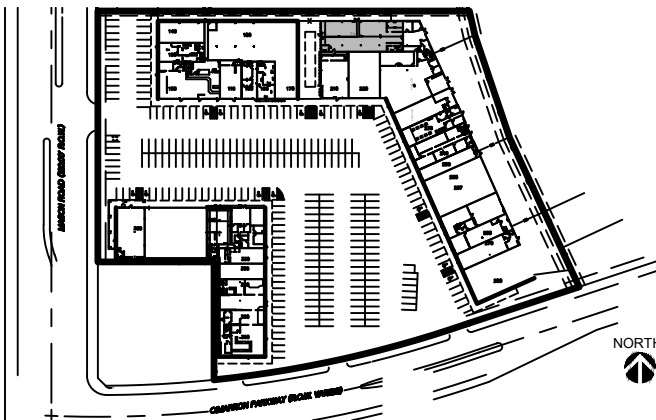
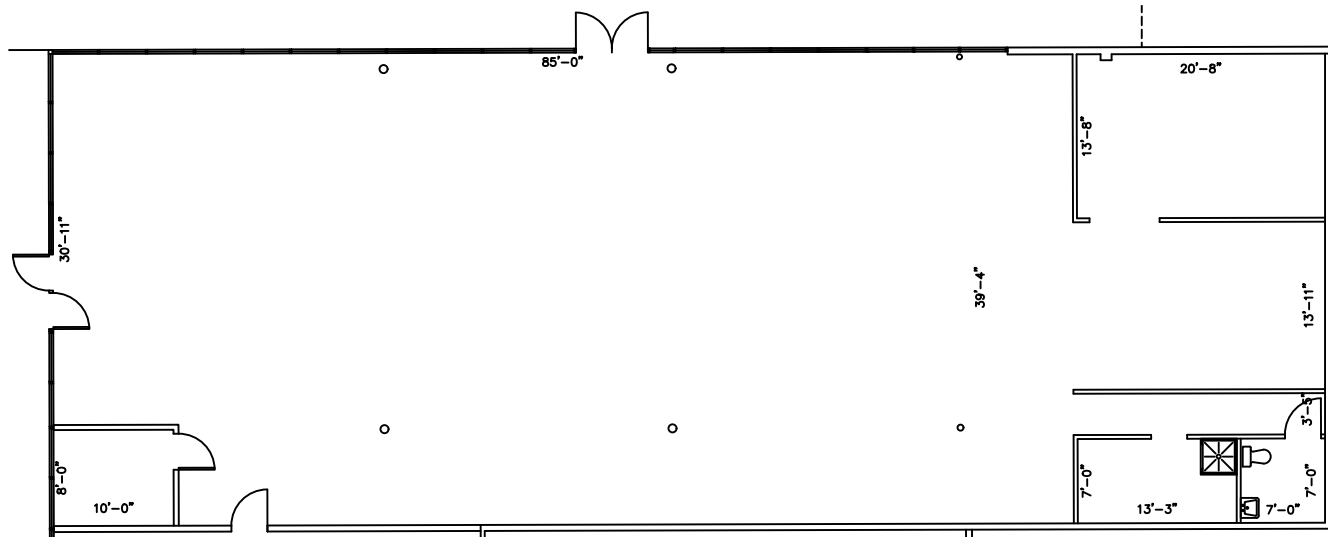

NORTH
SITE PLAN
KEY PLAN

SUITE 200a
4,251 NRA

1 FLOOR PLAN
SCALE: 1/16"=1'-0"